

- It can combine devices such as PLCs, meters, or sensors with RS485 communication protocols on site, conduct data collection and real-time monitoring of data.
- The base map can be produced according to the customer's own needs, and the data can be exported in Excel file format.
- Customers can use Excel built-in functions to create their own reports according to their own needs functions such as multiple types of curves and charts.  
It can enter up to 36 connection data, establish a simple and automated data collection scheme.  
It can also provide LCD displays of 18 to 32 "or above to enhance visual aesthetics and effects.
- Communication protocol: Modbus serial RTU **9600-N-8-1**.



## SPECIFICATION

- ◆ Equipped with Intel Braswell N3700 processor, using 14 nm process technology.
- ◆ Dual core 4G/64 bit, providing 2.24Ghz efficient computing power.
- ◆ Low power consumption requires only 1/10 of the power supply of the desktop computer.
- ◆ Equipped with Win10Pro operating system.
- ◆ Supports HDMI and D-Sub digital and analog output combinations.
- ◆ DDR3L 4GB memory.
- ◆ EMMC 64GB hard disk storage capacity.

## DIMENSION



## FEATURES & APPLICATIONS

### 1. Manually capturing data within a range

Select the required parameters, time interval range, and time interval interval from the "historical data", Export "Chart Data", "Report Data", and "Original Data".

會議室 溫度  
會議室 濕度  
會議室 PM2.5  
會議室 MP10  
會議室 CO2  
會議室 甲醛

**Chart Data**  
(Up to 9 simultaneous transactions)

	B	C	D	E	F
1	會議室 溫度	會議室 溫度	會議室 溫度	會議室 溫度	會議室 溫度
2	最大值	最小值	平均值	最大值	最小值
3	27.8	27.8	27.8	74.3	
4	27.8	27.8	27.8	74.3	
5	27.8	27.8	27.8	74.3	
6	27.8	27.8	27.8	74.2	
7	27.8	27.8	27.8	74.1	
8	27.9	27.8	27.82	74.2	
9	27.9	27.8	27.86	74.3	
10	27.8	27.8	27.8	74.4	
11	27.8	27.8	27.8	74.5	
12	27.8	27.8	27.8	74.6	
13	27.8	27.8	27.8	74.7	
14	27.8	27.8	27.8	74.8	
15				74.9	
16				75.1	
17				75.3	
18				75.4	
19				75.4	
20				75.5	
21				75.6	
22	27.8	27.8	27.8	75.6	
23	27.8	27.8	27.8	75.5	
24	27.8	27.8	27.8	75.7	
25	27.8	27.8	27.8		

**Report Data**

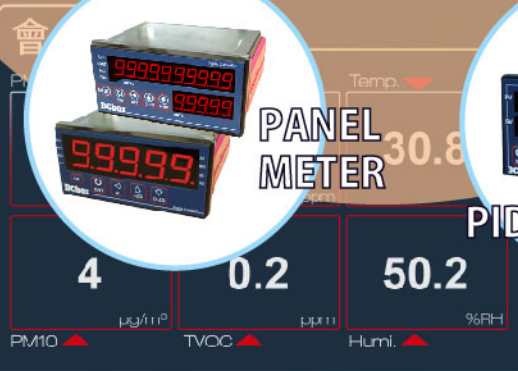
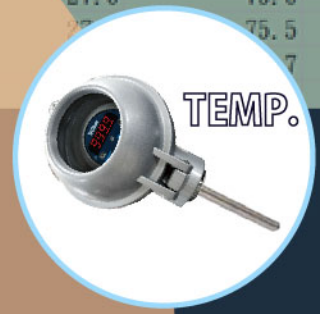

- ★ Draw a line chart using up to 9 simultaneous data and save it as a picture file (. PNG).
- ★ The report data is retrieved from the time interval set by "Historical Data", and the interval data is sorted into maximum, minimum, and average values, which are exported to Excel.
- ★ Original data: Export all data within the time interval to Excel.

## 2. Automatically store data on a USB flash drive.

IOT (D:) > 2022 > 06

名稱	修改日期	類型	大小
RawData20220607	2022/6/7 下午 11:59	Microsoft Excel ...	121 KB
RawData20220608	2022/6/8 下午 11:59	Microsoft Excel ...	232 KB
RawData20220609	2022/6/9 下午 11:59	Microsoft Excel ...	238 KB
RawData20220610	2022/6/10 下午 11:59	Microsoft Excel ...	234 KB
RawData20220611	2022/6/11 下午 11:59	Microsoft Excel ...	228 KB
RawData20220612	2022/6/12 下午 11:59	Microsoft Excel ...	231 KB
RawData20220613	2022/6/13 下午 11:59	Microsoft Excel ...	231 KB
RawData20220614	2022/6/15 上午 12:00	Microsoft Excel ...	230 KB
RawData20220615	2022/6/15 下午 11:59	Microsoft Excel ...	231 KB
RawData20220616	2022/6/16 下午 11:59	Microsoft Excel ...	232 KB
RawData20220617	2022/6/17 下午 11:59	Microsoft Excel ...	231 KB
RawData20220618	2022/6/18 下午 11:59	Microsoft Excel ...	228 KB
RawData20220619	2022/6/19 下午 11:59	Microsoft Excel ...	234 KB
RawData20220620	2022/6/20 下午 11:59	Microsoft Excel ...	235 KB
RawData20220621	2022/6/21 下午 11:59	Microsoft Excel ...	236 KB
RawData20220622	2022/6/22 下午 11:59	Microsoft Excel ...	228 KB
RawData20220623	2022/6/23 下午 11:59	Microsoft Excel ...	237 KB

According to the operation manual to set the relevant settings(In the unit of a day), then save the Excel file in the USB flash drive. The Excel (csv) file for self-use or data backup.

## 3. Draw the base map according to the requirements, and display the monitoring(up to 36 data).



## DUAL DISPLAY OUTPUT

LIVA XE supports HDMI and D-Sub digital plus analog output combinations provide **in-plant display (VGA)** and **remote monitoring (HDMI)** applications.



## VESA BRACKET INSTALLATION

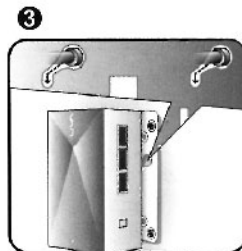
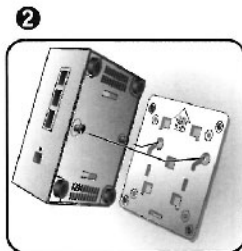
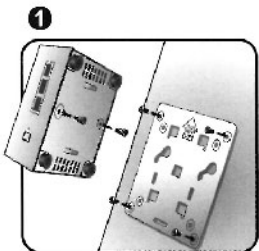
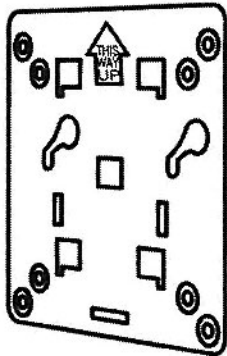

\*If it is disassembled many times, it may damage the elasticity of the heat dissipation pad and reduce the cooling effect.

\*Internal settings are only available for Modbus serial RTU 9600-N-8-1

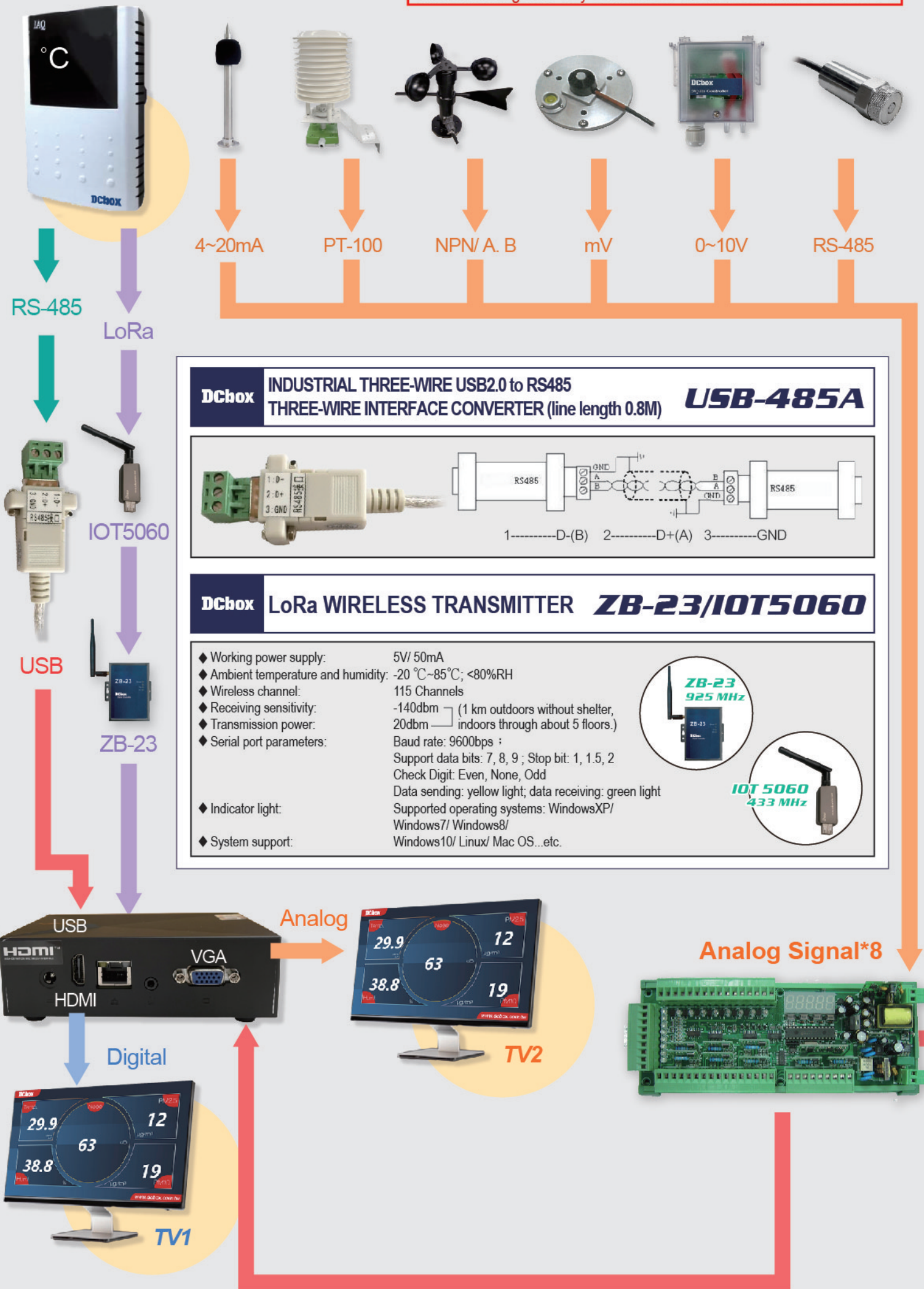

**DCbox INDUSTRIAL THREE-WIRE USB2.0 to RS485 THREE-WIRE INTERFACE CONVERTER (line length 0.8M) *USB-485A***

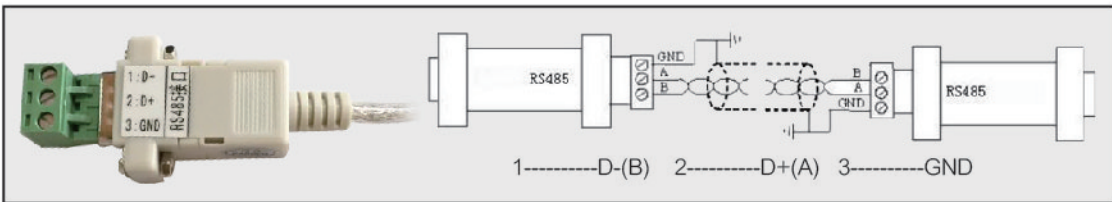

**DCbox LoRa WIRELESS TRANSMITTER *ZB-23/IOT5060***

- ◆ Working power supply: 5V/ 50mA
- ◆ Ambient temperature and humidity: -20 °C~85°C; <80%RH
- ◆ Wireless channel: 115 Channels
- ◆ Receiving sensitivity: -140dbm (1 km outdoors without shelter, indoors through about 5 floors.)
- ◆ Transmission power: 20dbm
- ◆ Serial port parameters: Baud rate: 9600bps ; Support data bits: 7, 8, 9 ; Stop bit: 1, 1.5, 2 Check Digit: Even, None, Odd Data sending: yellow light; data receiving: green light Supported operating systems: WindowsXP/ Windows7/ Windows8/ Windows10/ Linux/ Mac OS...etc.
- ◆ Indicator light:
- ◆ System support:

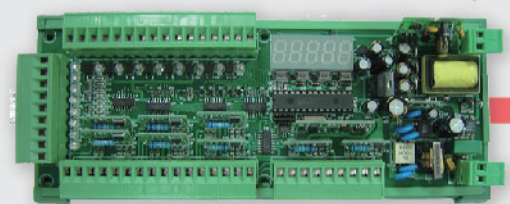
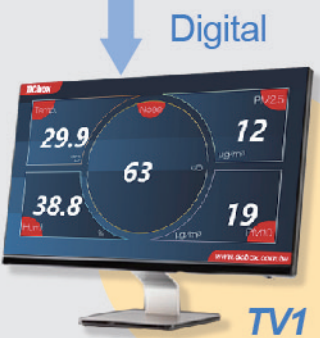

- Accuracy:  $\pm 0.1\%$  F.S.  $\pm 1$  digit (DC / PT-100).
- Measuring DC Voltage / DC Current / PT-100).
- High brightness 0.4" LED display range: -19999~19999; decimal point selectable.
- RS-485 communication optional.
- Din rail mounting, easily installation.

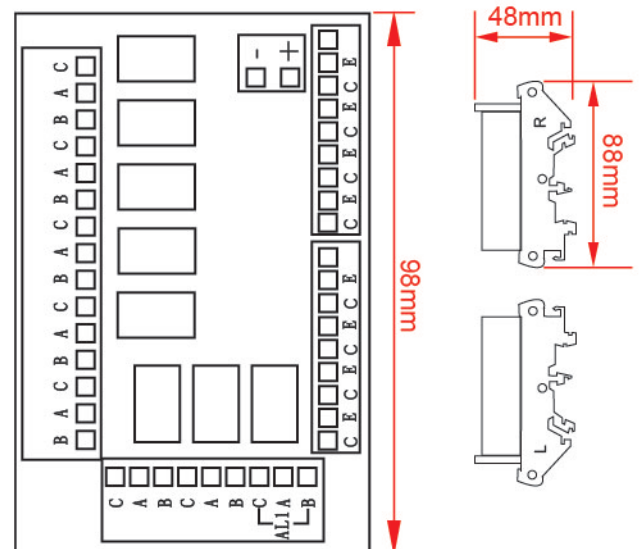
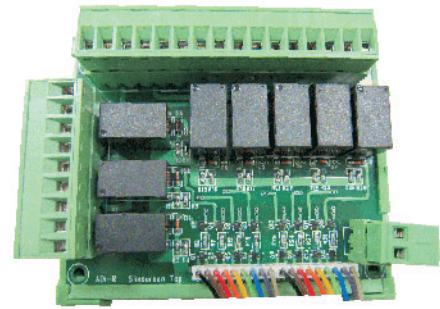
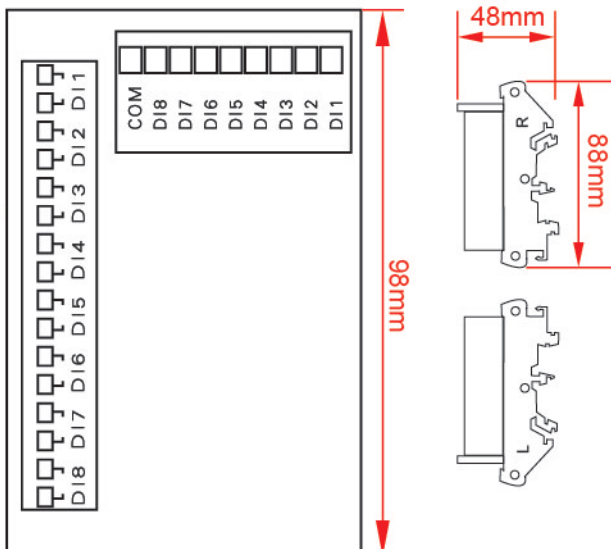
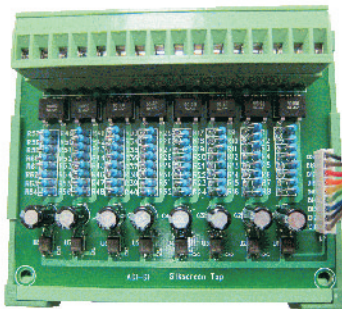
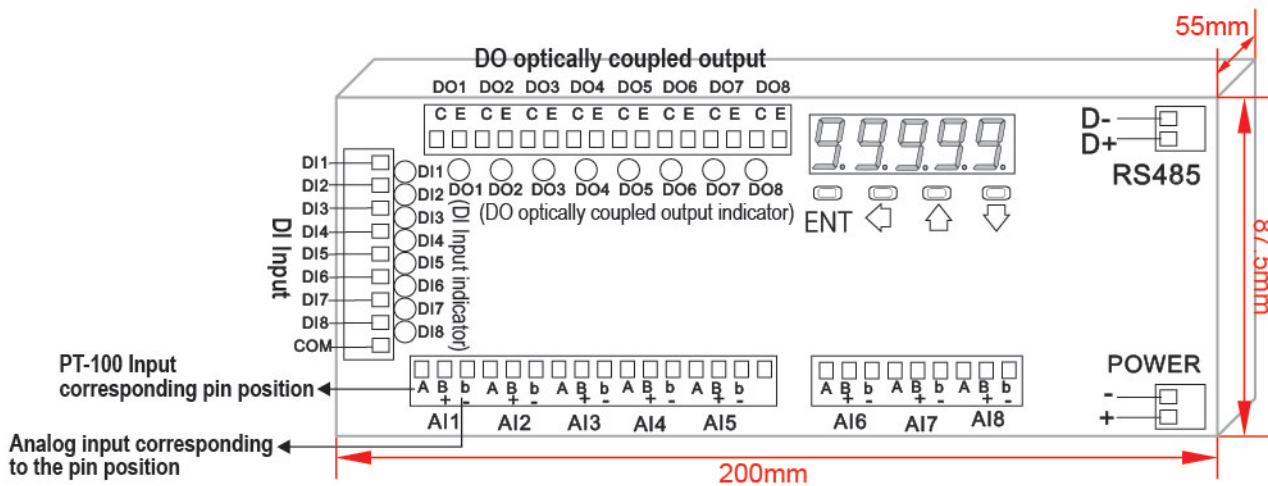
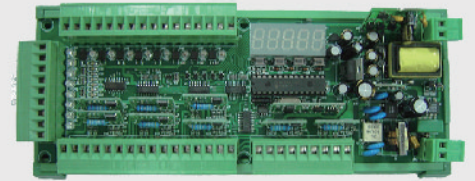

# POLYWELL HDMI AOC FIBER OPTIC CABLE 2.0 VERSION 50M

- Photoelectric conversion, no compressed signal.
- OM3 four-core smooth composite cable has strong anti-interference.
- 24K gold-plated terminal head, with high conductivity and difficult oxidation.
- Aluminum alloy shell plug, high texture, good shielding.
- Long-distance transmission, near zero attenuation.
- Up to 100 meters transmission distance.
- Four-core smooth composite cable has strong anti-interference performance.
- Aramid fiber filling, strong tensile strength.
- 50% wire diameter, making construction easier.
- Product specifications: 4K2K 3840x2160 @ 60Hz.
- Suitable model: suitable for connecting digital TV box, MOD, Blu-ray player, digital multimedia set-top box, PS4, X-Box, computer display card, computer display screen, projector, etc.
- Suitable for home theater, large conference room, teaching audio-visual room, advertising billboard construction special wire rod.



## SPECIFICATION

- ◆ Brand: POLYWELL
- ◆ Type: HDMI audio and video transmission line
- ◆ Model: PW15-W60-Q050
- ◆ Color: black series
- ◆ Line length: more than 10m
- ◆ Origin: China
- ◆ Size: 50M
- ◆ Weight: 1560g
- ◆ Warranty: one year

## PRECAUTIONS for FIBER OPTIC CABLE INSTALLATION

This type of cable is directional during installation.

Please pay attention to the installation direction.

It is recommended to connect to your device for testing before wiring.

The connector is marked "Source" and must be installed directly on the player, computer host, or HDMI with power supply. On the distributor, short lines or information panels cannot be connected. (DP to HDMI active adapter OK) The connector is marked "Display" and it is recommended to install it directly on the display device to avoid attenuation caused by the transfer.

It can also be connected to the information panel and add an HDMI 2.0 cable, but it is recommended not to transfer the length exceeding 3M. If you need to connect optical fiber cables in series or transfer the information panel, please call our technical colleagues first to inquire whether it is suitable.