

- High-precision, measuring range is up to 30dB~130dB.
- It is made of stainless steel to maintain its luster after use for a long time.
- The housing is designed with threads for easy and quick installation.
- With a capacitive microphone, stable signal and high accuracy.
- Wide measurement range, good linearity, convenient, and easy installation.
- Using RS-485 output signal, can communicate up to 2000 meters, using standard Modbus protocol, support for secondary development.



SPECIFICATION

- ◆DC power supply: 10~30V DC
- ◆Maximum power consumption: Current output 0.15W
- ◆Resolution: 0.1dB
- ◆Working environment: -20~+60°C, 0%RH~95%RH (non-condensing)
- ◆Measuring range: 30dB~120dB
- ◆Frequency range: 20Hz~12.5kHz
- ◆Response time: ≤ 3s
- ◆Stability: Less than 2% during use
- ◆Noise accuracy: ±0.5dB (in reference pitch, 94dB@1kHz)
- ◆Output signal: Current output 4~20mA, RS-485
- ◆UART and RS-485 parameter: N. 8. 1
- ◆Load capacity: Current output ≤ 600Ω

ORDER INFORMATION

NSZS - Code1 - Code2 - Code3

Code1	Output Signal	Code2	Installation	Code3	Wire length
4A6	4~20mA Current	BK	Bracket	N	50cm
Y	RS-485			5	5M
				10	10M
				0	Option

DIMENSION

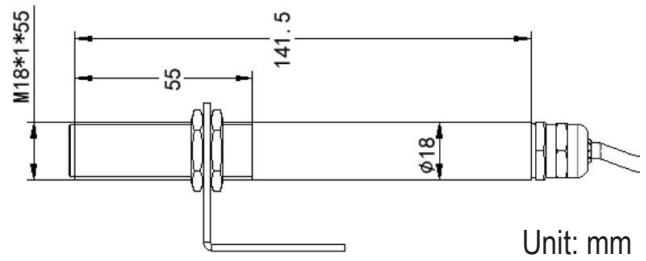

WIRING CONNECTION

- Power** Brown: Power+
Black: Power-
- Signal** Blue: Noise signal+
Green: Noise signal-

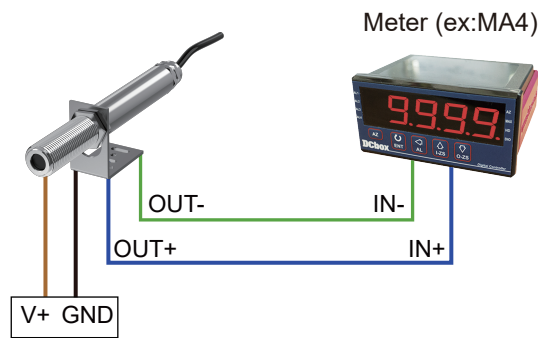

- RS-485
- Power** Brown: Power+(10~30Vdc)
Black: Power-
- Signal** Yellow: 485-A
Blue: 485-B

