

- Alloy steel & aluminum alloy structure.
- Glue sealing. simple and reliable, better exchangeability.
- Suitable for multiform environments, force control in production process, vibratory feeding equipment and other electronic weighing devices.
- Rated load: 5kg~500kg

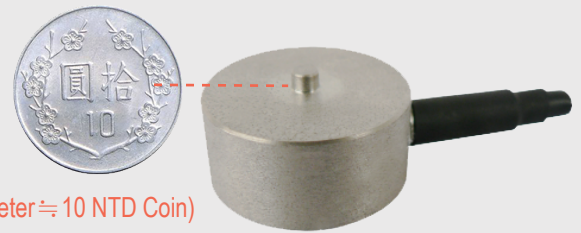

(Round Diameter ≈ 10 NTD Coin)

SPECIFICATION

- | | | | |
|-------------------------|-------------------------------------------------|--------------------------|-----------------|
| ◆ Rated Load | : 5kg/ 10kg/ 20kg/ 50kg/
100kg/ 200kg/ 500kg | ◆ Temp.effect on span | : ±0.5 %FS/10°C |
| ◆ Comprehensive Error | : ±0.2 %FS | ◆ Temp.effect on zero | : ±0.5 %FS/10°C |
| ◆ Rated output | : 1.0±0.1mV/V | ◆ Compensated temp.range | : -10~+40 °C |
| ◆ Creep | : ±0.1 %FS/10min | ◆ Use temp.range | : -20~+55 °C |
| ◆ Zero balance | : ±10.0 %FS | ◆ Excitation voltage | : 9~12 VDC |
| ◆ Input resistance | : 350±10 Ω | ◆ Safe overload | : 120 % |
| ◆ Output resistance | : 350±10 Ω | ◆ Ultimate overload | : 150% |
| ◆ Insulation resistance | : ≥1000MΩ(100VDC) | ◆ Defend grade | : IP66 |

ORDER INFORMATION

LRS - Code1

Code1	Rated Load(kg)
05	5
10	10
20	20
50	50

WIRING CONNECTION

● 4 Wire : Ø3*2000mm

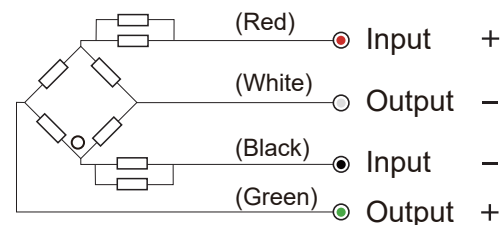

DIMENSION

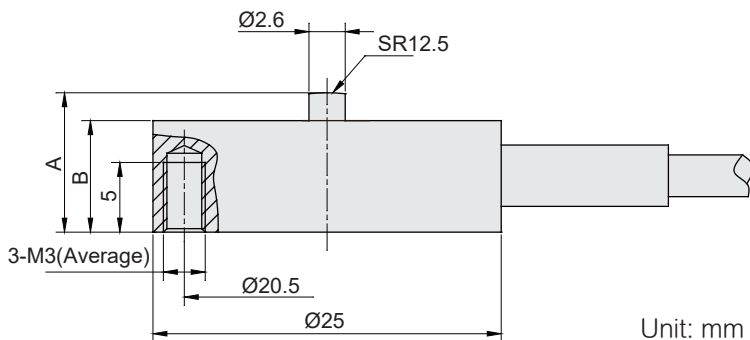

Rated Load	5	10	20	50	100	200	500
A	10	11	11	11	11	11	15
B	8	9	9	9	9	9	12

LOAD INSTRUCTION

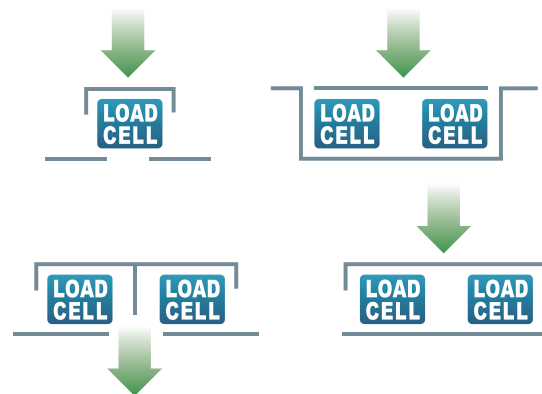

**100~500kg range is made of alloy steel. Other ranges are made of aluminum alloy.